

INTRODUCTION

Al Rawaa General Trading (ARGT), based in United Arab Emirates, is a one-stop-shop casters manufacturing company. From design to production to quality control to delivery, we make the entire process seamless.

ARGT is a U.A.E. based company with principle design and production platforms in China. This set-up allows for even the most radical audacious casters to be manufactured. Furthermore, China based manufacturing creates a cost-effectiveness that is unparalleled in the industry. Our quality control measures are as stringent as mandated by the internationally accepted Standards. Our factory is ISO 9001 certified.

Our commitment to quality and performance, cost-effective and service, and attention to detail brings value to all. We welcome low volume OEM. Between ARGT and our factory partners, we serve customer from all over the world.



Factory



Injection Workshop



Corrosion Testing Equipment



Assembling Workshop



Temperature Testing Equipment



Dynamic Load Testing Equipment Machine



Durometer Testing Equipment

| Series | Wheel Size | Finish | Fork | Brake | Wheel Material | Bearing |
|--------|------------|--------|------|-------|----------------|---------|
|--------|------------|--------|------|-------|----------------|---------|

| | | | | | | | | |
|----------------------|--|--------------------------------|--|--------------------------------|--|--|--|--|
| 42 | MEDIUM/LIGHT DUTY CASTER SERIES | 1" /10 | Zinc Plated / 1 | Top Plate Rigid / 1 | Non Lock Brake (Rigid) / 0 | 10 YUPA(One moulding Advanced Polyolefin) | | Four Ball Bearing / 0 |
| 51 | MEDIUM DUTY CASTER SERIES | 1.6" /16 | Black Color Paint / 3 | Top Plate Swivel / 2 | Side Lock Brake (Metal) / 1 | 11 YUPA(Twice moulding Advanced Polyolefin) | | Rivet / 1 |
| 52 | MEDIUM DUTY CASTER SERIES | | | | | 12 PP Polyolefin(flat tread) | | |
| 62 | MEDIUM/HEAVY DUTY CASTER SERIES | 2" /20 | Yellow Zinc Plated / 4 | Threaded Stem/ 3 | Wheel Lock Brake (Metal) / 2 | 13 PP H-tech Polyolefin(flat tread) | | Nylon Bushing Bearing / 2 |
| 72 | HEAVY DUTY CASTER SERIES | 2.5" /25 | Chrome Plated / 5 | Hollow Rivet / 4 | Total Lock Brake (Metal) / 3 | 14 YUPA Polyolefin(round tread) | | |
| 73 | HEAVY DUTY CASTER SERIES | 3" /30 | Wrinkle Black Color Paint / 6 | Ring Stem / 5 | Total Lock Brake (Plastic) / 4 | 20 PU Super strong PU wheel(flat tread) | | Annular Bearing / 3 |
| A1 | LOW GRAVITY CASTER SERIES | 4" /40 | | Grip Ring Stem / 6 | Wheel Lock Brake (Plastic) / 5 | 21 PU Hi-class PU wheel(flat tread) | | |
| A2 | HEAVY DUTY LOW GRAVITY CASTER SERIES | 5" /50 | Expanding Stem / 7 | Square Stem / 8 | Separate total Lock Brake(Metal) / 6 | 22 PU Polyurethane(flat tread) | | Stamping Ball Bearing / 4 |
| A3 | EXTRA HEAVY DUTY LOW GRAVITY CASTER SERIES | 6" /60 | | | Separate total Lock Brake(Plastic) / 7 | 23 PU Hi-tech Polyurethane (flat tread) | | |
| B1 | CONDUCTIVE CASTER SERIES | 8" /80 | SHOCK ABSORBING CASTER SERIES | 10" /100 | Nylon w/pattern(round tread) | 24 PU Upgrade PU(flat tread) | | Single Ball Bearing / 5 |
| C1 | HIGH-TEMP. RESISTANCE CASTER SERIES | 12" /120 | | | | 25 PU Injection Polyurethane wheel(flat tread) | | |
| C2 | HIGH-TEMP. RESISTANCE CASTER SERIES | MEDICAL CASTER SERIES | MEDICAL CASTER SERIES | MEDICAL CASTER SERIES | MEDICAL CASTER SERIES | 27 PU Hi-tech Polyurethane (round tread) | | Double Ball Bearing / 6 |
| D1 | SHOCK ABSORBING CASTER SERIES | | | | | 6" /60 | 32 PU Aluminium/Urethane wheel(flat tread) | |
| E3 | FOAM CASTER SERIES | 8" /80 | 33 PU Iron/Urethane wheel(round tread) | | 40 PA Plastic Nylon(flat tread) | | PA Nylon(Hi-temp) | |
| G3 | PNEUMATIC CASTER SERIES | 10" /100 | 34 PU Iron/Urethane wheel(round tread) | | 41 PA Iron Nylon(flat tread) | | | |
| H7 | MEDICAL CASTER SERIES | MEDICAL CASTER SERIES | MEDICAL CASTER SERIES | MEDICAL CASTER SERIES | MEDICAL CASTER SERIES | 42 Nylon w/pattern(round tread) | | ER Elastic rubber(flat tread) |
| H8 | MEDICAL CASTER SERIES | | | | | 12" /120 | 48 PA Nylon(Hi-temp) | |
| H9 _(2.5") | MEDICAL CASTER SERIES | EXTRA HEAVY DUTY CASTER SERIES | EXTRA HEAVY DUTY CASTER SERIES | EXTRA HEAVY DUTY CASTER SERIES | EXTRA HEAVY DUTY CASTER SERIES | 50 ER Elastic rubber(flat tread) | | ER Super strong elastic rubber(flat tread) |
| H9 _(3") | MEDICAL CASTER SERIES | | | | | 51 ER Super strong elastic rubber(flat tread) | | |
| 92 | EXTRA HEAVY DUTY CASTER SERIES | TROLLEY CASTER SERIES | TROLLEY CASTER SERIES | TROLLEY CASTER SERIES | TROLLEY CASTER SERIES | 52 ER Iron casing elastic rubber(flat tread) | | ER Iron elastic rubber(flat tread) |
| T1 | TROLLEY CASTER SERIES | | | | | 53 ER Iron elastic rubber(flat tread) | | |
| | | | | | | 61 TPR wheel (flat tread) | | TPR wheel (round tread) |
| | | | | | | 62 TPR wheel (round tread) | | |
| | | | | | | 63 TPR wheel (conductive) | | ER Foam rubber wheel |
| | | | | | | 71 ER Foam rubber wheel | | |
| | | | | | | 72 ER Pneumatic rubber | | Cast Iron (flat tread) |
| | | | | | | 80 Cast Iron (flat tread) | | |
| | | | | | | 90 PVC wheel (round tread) | | |

CONTENT

| | |
|---|---------|
| INTRODUCTION | P_01 |
| INTRODUCTION OF PRODUCTION AND TESTING EQUIPMENTS | P_02 |
| ARTICLE NO.INTRUCTION | P_03/04 |
| CONTENT | P_05/06 |
| 42 SERIES MEDIUM/LIGHT DUTY CASTER SERIES | P_07/08 |
| 51/52 SERIES MEDIUM DUTY CASTER SERIES | P_09/12 |
| 62 SERIES MEDIUM/HEAVY DUTY CASTER SERIES | P_13/14 |
| 72/73 SERIES HEAVY DUTY CASTER SERIES | P_15/18 |
| A1 SERIES LOW GRAVITY CASTER SERIES | P_19 |
| A2 SERIES HEAVY DUTY LOW GRAVITY CASTER SERIES | P_20 |
| A3 SERIES EXTRA HEAVY DUTY LOW GRAVITY CASTER SERIES | P_21 |
| B1 SERIES CONDUCTIVE CASTER SERIES | P_22 |
| C1/C2 SERIES HIGH TEMP. RESISTANCE CASTER SERIES | P_23/24 |
| D1 SERIES SHOCK ABSORBING CASTER SERIES | P_25/26 |
| E3 SERIES FOAM CASTER SERIES | P_27 |
| G3 SERIES PNEUMATIC CASTER SERIES | P_28 |
| H7/H8/H9 MEDICAL CASTER SERIES | P_29/32 |
| T1 TROLLEY CASTER SERISE | P_33 |
| 92 EXTRA HEAVY DUTY CASTER SERIES | P_34 |





42 SERIES MEDIUM/LIGHT DUTY DOUBLE BALL BEARING SERIES

Wheel Dia **2.5"~4"**

Load Capacity **55~100kg**

Wheel Option **2.5"~4"** | 42 Series Capacity **55 ~ 100 Kg**



YUPA116

Tread Width **28(mm)**
2.5" / **75kg**
3" / **85kg**
4" / **100kg**



PU236

Tread Width **28(mm)**
2.5" / **70kg**
3" / **80kg**
4" / **95kg**



PU286

Tread Width **28(mm)**
2.5" / **65kg**
3" / **70kg**
4" / **70kg**



TPR626

Tread Width **28(mm)**
2.5" / **55kg**
3" / **65kg**
4" / **70kg**

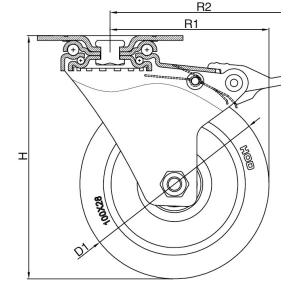

Spec. Demonstration



2.5"~4" Fork Option Black/Zinc



4230310
Top Plate Rigid



4230320
Top Plate Swivel



4230324
Swivel Total Lock
(Plastic)



4230330
Threaded Stem



4230334
Threaded Total Lock
(Plastic)



4230340
Hollow Rivet



4230344
Hollow Rivet Total Lock
(Plastic)



4230360
Grip Ring



4230364
Grip Ring Total Lock
(Plastic)

| Wheel Dia (in) | Tread Width (mm) | Load Height (mm) | Swivel Radius S1/S2 (mm) | Plate Size A1xB1 (mm) | Plate Size A2xB2/A3xB2(mm) | Hole Size (mm) | Thread Size (mm) | Hollow Size (mm) | Grip Ring Stem (mm) |
|----------------|------------------|------------------|--------------------------|-----------------------|----------------------------|----------------|------------------|------------------|---------------------|
| 2.5" | 28 | 91.5 | 62.5 / 93 | 80 X 58 | A2xB2:60x40 A3xB2:55x40 | 8.2 | M12x25 | 10.2 | 11x38 |
| 3" | 28 | 103 | 69.5 / 93 | 80 X 58 | A2xB2:60x40 A3xB2:55x40 | 8.2 | M12x25 | 10.2 | 11x38 |
| 4" | 28 | 128.5 | 84 / 97 | 80 X 58 | A2xB2:60x40 A3xB2:55x40 | 8.2 | M12x25 | 10.2 | 11x38 |



4230364-626

| | | | | | | | |
|--------------------|-------------------|------------|-------------------|-----------|----------------------------|----------------|---------------------|
| Caster Item Number | Medium/Light Duty | Wheel Size | Black Color Paint | Grip Ring | Total Lock Brake (Plastic) | Wheel Material | Double Ball Bearing |
|--------------------|-------------------|------------|-------------------|-----------|----------------------------|----------------|---------------------|

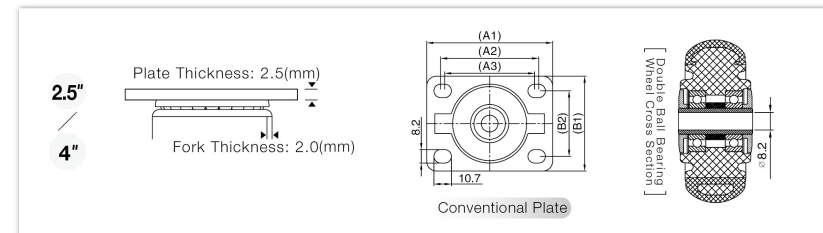



51 SERIES MEDIUM DUTY SINGLE BALL BEARING SERIES

Wheel Dia 1.6"~5"

KG 30~160kg

Wheel Option 1.6"~5" | 51 Series Capacity 30~160Kg

| | | | | | |
|-------------------------|-------------------------|-------------------------|-------------------------|-------------------------|-------------------------|
| | | | | | |
| PP125 | PP135 | PU205 | PU215 | PU235 | ER505 |
| Wear Width 22/26/32(mm) | Wear Width 22/26/32(mm) | Wear Width 22/26/32(mm) | Wear Width 22/26/32(mm) | Wear Width 22/26/32(mm) | Wear Width 22/26/32(mm) |
| 1.6" / 40kg | 1.6" / 40kg | 1.6" / 30kg | 2.5" / 100kg | 1.6" / 35kg | 2.5" / 70kg |
| 2" / 55kg | 2" / 55kg | 2" / 45kg | 3" / 115kg | 2" / 50kg | 3" / 90kg |
| 2.5" / 100kg | 2.5" / 100kg | 2.5" / 95kg | 4" / 140kg | 2.5" / 105kg | 4" / 120kg |
| 3" / 120kg | 3" / 120kg | 3" / 110kg | 5" / 155kg | 3" / 120kg | 5" / 130kg |
| 4" / 140kg | 4" / 140kg | 4" / 135kg | | 4" / 145kg | |
| 5" / 150kg | 5" / 150kg | 5" / 150kg | | 5" / 160kg | |

1.6"~5" Fork Option Zinc/Black

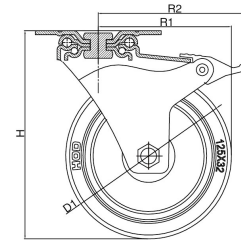
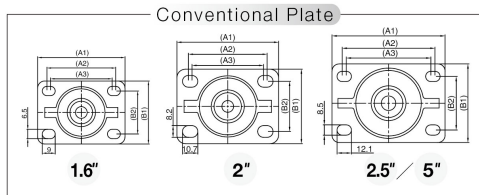

Spec. Demonstration



| Wheel Dia (in) | Tread Width (mm) | Load Weight (mm) | Swivel Radius S1/S2/S3 (mm) | Plate Size A1xB1 (mm) | Plate Size A2xB2/A3xB2 (mm) | Hole Size (mm) | Thread Size (mm) | Hollow Size (mm) |
|----------------|------------------|------------------|-----------------------------|-----------------------|-----------------------------|----------------|------------------|------------------|
| 1.6" | 22 | 61.5 | 45 / 67 | 61 X 44 | A2xB2:48x30 A3xB2:43x30 | 6.5 | M8x20 | / |
| 2" | 26 | 74.5 | 53 / 76 | 71 X 52 | A2xB2:55x35 A3xB2:50x35 | 8.2 | M10x25 | / |
| 2.5" | 32 | 94 | 66.5 / 70 / 102 | 95 X 66 | A2xB2:78x45 A3xB2:71x45 | 8.5 | M12x25 | ∅12 |
| 3" | 32 | 106 | 72.5 / 72.5 / 102 | 95 X 66 | A2xB2:78x45 A3xB2:71x45 | 8.5 | M12x25 | ∅12 |
| 4" | 32 | 131 | 85 / 85 / 107 | 95 X 66 | A2xB2:78x45 A3xB2:71x45 | 8.5 | M12x25 | ∅12 |
| 5" | 32 | 157 | 100.5/100.5/113 | 95 X 66 | A2xB2:78x45 A3xB2:71x45 | 8.5 | M12x25 | ∅12 |

Brake Options



5140123-205

Medium Duty | Wheel Size | Zinc Plated | Swivel | Total Lock Brake (Metal) | Wheel Material | Single Ball Bearing

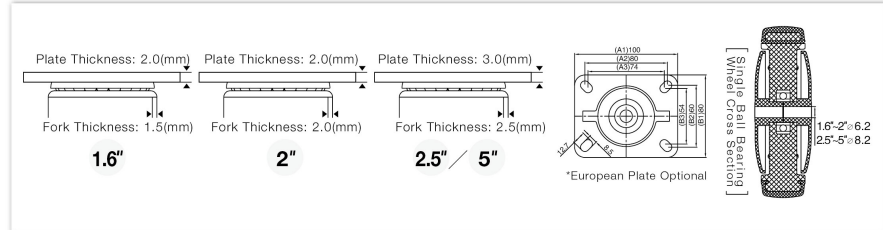



52 SERIES MEDIUM DUTY DOUBLE BALL BEARING SERIES

Wheel Dia **1.6"~5"**

KG **35~170kg**

Wheel Option **1.6"~5"** | 52 Series Capacity **35~170Kg**

| | | | | | | |
|--|--|--|--|--|--|---|
| | | | | | | |
| PP106 ■ | PU206 ■+■ | PU226 ■+■ | PU236 ■+■ | PU286 ■+■ | PA406 ■+■ | TPR616 ■+□ |
| Tread Width 22/26/32(mm) 1.6" / 45kg 2" / 60kg 3" / 115kg 4" / 140kg 5" / 160kg | Tread Width 22/26/32(mm) 1.6" / 35kg 2" / 50kg 3" / 115kg 4" / 140kg 5" / 155kg | Tread Width 22/26/32(mm) 3" / 120kg 4" / 145kg 5" / 160kg | Tread Width 22/26/32(mm) 1.6" / 40kg 2" / 55kg 3" / 120kg 4" / 145kg 5" / 160kg | Tread Width 22/26/32(mm) 3" / 100kg 4" / 130kg 5" / 140kg | Tread Width 22/26/32(mm) 3" / 135kg 4" / 155kg 5" / 170kg | Tread Width 22/26/32(mm) 1.6" / 35kg 2" / 40kg 3" / 90kg 4" / 110kg 5" / 120kg |

1.6"~5" Fork Option Zinc/Black

| | | | | | | |
|----------------------------|--|---|---|--------------------------|--|---|
| | | | | | | |
| 5240110 Top Plate Rigid | 5240120 Top Plate Swivel | 5240121 Swivel Side Lock (Metal) | 5240123 Swivel Total Lock (Metal) | 5240130 Threaded Stem | 5240131 Threaded Side Lock (Metal) | 5240133 Threaded Total Lock (Metal) |
| | | | <p>Conventional Plate</p> | | | |
| 5240140 Hollow Rivet | 5240141 Hollow Rivet Side Lock (Metal) | 5240143 Hollow Rivet Total Lock (Metal) | 1.6" | 2" | 3" / 5" | |



| Wheel Dia (in) | Tread Width (mm) | Load Weight (mm) | Swivel Radius S1/S2/S3 (mm) | Plate Size A1xB1 (mm) | Plate Size A2xB2/A3xB2 (mm) | Hole Size (mm) | Thread Size (mm) | Hollow Size (mm) |
|----------------|------------------|------------------|-----------------------------|-----------------------|-----------------------------|----------------|------------------|------------------|
| 1.6" | 22 | 61.5 | 45 / 67 | 61 X 44 | A2xB2:48x30 A3xB2:43x30 | 6.5 | M8x20 | / |
| 2" | 26 | 74.5 | 53 / 76 | 71 X 52 | A2xB2:55x35 A3xB2:50x35 | 8.2 | M10x25 | / |
| 3" | 32 | 106 | 72.5 / 72.5 / 102 | 95 X 66 | A2xB2:78x45 A3xB2:71x45 | 8.5 | M12x25 | ∅12 |
| 4" | 32 | 131 | 85 / 85 / 107 | 95 X 66 | A2xB2:78x45 A3xB2:71x45 | 8.5 | M12x25 | ∅12 |
| 5" | 32 | 157 | 100.5/100.5/113 | 95 X 66 | A2xB2:78x45 A3xB2:71x45 | 8.5 | M12x25 | ∅12 |

| | | | | |
|-----------------------|--|---------------|--|--|
| | | | | |
| Fork Finished Options | | Brake Options | | |

| | | | | | | |
|--------------------|--------------------|------------|-------------------|---------------|----------------------------|------------------------------------|
| | 5240334-226 | | | | | |
| Sample Item Number | Medium Duty | Wheel Size | Black Color Paint | Threaded Stem | Total Lock Brake (Plastic) | Wheel Material Double Ball Bearing |

| | | | |
|--------------------------|--------------------------|--------------------------|---------------------------|
| Plate Thickness: 2.0(mm) | Plate Thickness: 2.0(mm) | Plate Thickness: 3.0(mm) | |
| Fork Thickness: 1.5(mm) | Fork Thickness: 2.0(mm) | Fork Thickness: 2.5(mm) | 16"-2":∅6.2 3"-5":∅8.2 |
| 1.6" | 2" | 3" / 5" | |



62
SERIES

MEDIUM/HEAVY DUTY DOUBLE BALL BEARING SERIES



3"~6"



90~330kg

Wheel Option 3"~6" | 62 Series Capacity **90~330Kg**



PP126

| |
|--------------------|
| Tread Width 38(mm) |
| 3" / 170kg |
| 4" / 210kg |
| 5" / 280kg |
| 6" / 310kg |



PU226

| |
|--------------------|
| Tread Width 38(mm) |
| 3" / 140kg |
| 4" / 170kg |
| 5" / 210kg |
| 6" / 240kg |



PU236

| |
|--------------------|
| Tread Width 38(mm) |
| 3" / 150kg |
| 4" / 180kg |
| 5" / 220kg |
| 6" / 250kg |



PA406

| |
|--------------------|
| Tread Width 38(mm) |
| 3" / 180kg |
| 4" / 215kg |
| 5" / 300kg |
| 6" / 330kg |



ER516

| |
|--------------------|
| Tread Width 38(mm) |
| 3" / 90kg |
| 4" / 135kg |
| 5" / 160kg |
| 6" / 175kg |

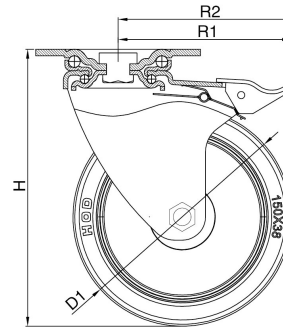

Spec. Demonstration



3"~6" Fork Option Black/Zinc



6250310
Top Plate Rigid



6250320
Top Plate Swivel



6250321
Swivel Side Lock (Metal)



6250323
Swivel Total Lock (Metal)



6250330
Threaded Stem



6250331
Threaded Side Lock (Metal)



6250333
Threaded Total Lock (Metal)



6250340
Hollow Rivet



6250341
Hollow Rivet Side Lock (Metal)



6250343
Hollow Rivet Total Lock (Metal)

| Wheel Dia (in) | Tread Width (mm) | Load Height (mm) | Swivel Radius S1/S2/S3 (mm) | Plate Size A1xB1 (mm) | Plate Size A2xB2/A3xB3(mm) | Hole Size (mm) | Thread Size (mm) | Hollow Size (mm) |
|----------------|------------------|------------------|-----------------------------|-----------------------|----------------------------|----------------|------------------|------------------|
| 3" | 38 | 111 | 72.5/76.5/102.5 | 101x82 | A2xB2:80x60 A3xB3:73x53 | 11 | M16x35 | φ16 |
| 4" | 38 | 136 | 85/85/107.5 | 101x82 | A2xB2:80x60 A3xB3:73x53 | 11 | M16x35 | φ16 |
| 5" | 38 | 163 | 102.5/102.5/118.5 | 113x99 | A2xB2:88x75 A3xB3:81x68 | 11 | M20x40 | φ16 |
| 6" | 38 | 190 | 119/119/123 | 113x99 | A2xB2:88x75 A3xB3:81x68 | 11 | M20x40 | φ16 |



Blue Zinc



Black Color Paint

Fork Finished Options



Metal Side Lock



Metal Total Lock

Brake Options



Sample Item Number

6250323-406

Medium/Heavy Duty | Wheel Size | Black Color Paint | Swivel | Total Lock Brake (Metal) | Wheel Material | Double Ball Bearing

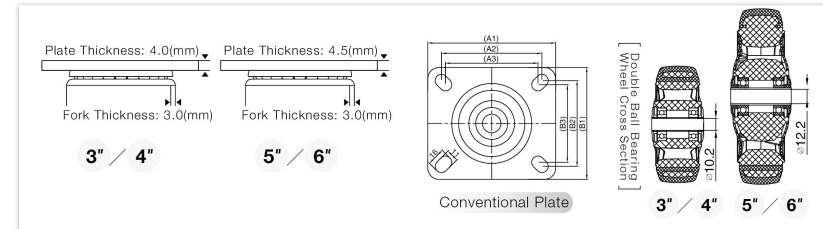



72 SERIES HEAVY DUTY DOUBLE BALL BEARING SERIES

Wheel Dia **4"~8"**

Load Capacity **230~480kg**

Wheel Option 4"~8" | 72 Series Capacity 230~480Kg



PU106

Tread Width 48(mm)
4" / 290kg
5" / 350kg
6" / 420kg
8" / 480kg



PU206

Tread Width 48(mm)
4" / 230kg
5" / 300kg
6" / 360kg
8" / 410kg



PU226

Tread Width 48(mm)
4" / 250kg
5" / 320kg
6" / 380kg
8" / 430kg

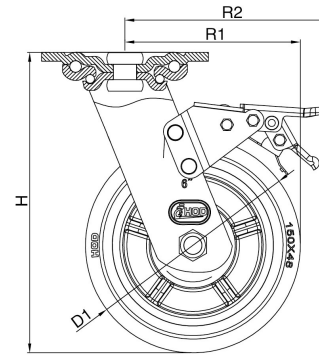

Spec. Demonstration



4"~8" Zinc Plated Fork



7260110
Top Plate Rigid



7260120
Top Plate Swivel



7260121
Swivel Side Lock
(Metal)



7260123
Swivel Total Lock
(Metal)

| Wheel Dia (in) | Tread Width (mm) | Load Height (mm) | Swivel Radius S1/S2/S3 (mm) | Plate Size A1xB1 (mm) | Plate Size A2xB3/A3xB2 (mm) | Hole Size (mm) |
|----------------|------------------|------------------|-----------------------------|-----------------------|------------------------------|----------------|
| 4" | 48 | 144 | 82 / 92 / 125 | 115x100 | A2xB3: 92x67 A3xB2: 76x76 | 11 |
| 5" | 48 | 165 | 96.5 / 96.5 / 130 | 115x100 | A2xB3: 92x67 A3xB2: 76x76 | 11 |
| 6" | 48 | 191 | 114 / 114 / 140 | 115x100 | A2xB3: 92x67 A3xB2: 76x76 | 11 |
| 8" | 48 | 242 | 150 / 150 / 150 | 115x100 | A2xB3: 92x67 A3xB2: 76x76 | 11 |

Brake Options



Sample Item Number

7260123-206

Heavy Duty | Wheel Size | Zinc Plated | Swivel | Total Lock Brake (Metal) | Wheel Material | Double Ball Bearing

4"
/
8"

Plate Thickness: 5.0(mm)
Fork Thickness: 5.0(mm)

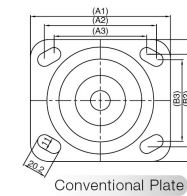

Conventional Plate

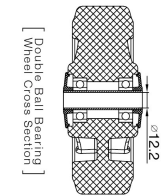

[Double Ball Bearing] Wheel Cross Section



73 HEAVY DUTY DOUBLE BALL BEARING SERIES

Wheel Dia 4"~8"

Load Capacity 130~505kg

Wheel Option 4"~8" | 73 Series Capacity 130~505Kg



PP146

Tread Width 48(mm)
4" / 280kg
5" / 340kg
6" / 420kg
8" / 450kg



PU246

Tread Width 48(mm)
4" / 280kg
5" / 350kg
6" / 400kg
8" / 450kg



PU276

Tread Width 49(mm)
4" / 240kg
5" / 295kg
6" / 355kg
8" / 385kg



PU296

Tread Width 45(mm)
4" / 270kg
5" / 330kg
6" / 380kg
8" / 420kg



PU306

Tread Width 50(mm)
4" / 280kg
5" / 350kg
6" / 400kg
8" / 450kg



PU346

Tread Width 48(mm)
4" / 290kg
5" / 385kg
6" / 440kg
8" / 505kg



PA426

Tread Width 45(mm)
4" / 300kg
5" / 360kg
6" / 430kg
8" / 480kg



ER516

Tread Width 48(mm)
4" / 200kg
5" / 250kg
6" / 340kg
8" / 430kg



TPR626

Tread Width 50(mm)
4" / 130kg
5" / 160kg
6" / 210kg
8" / 250kg

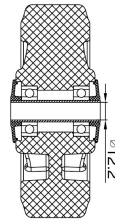

[Double Ball Bearing Wheel Cross Section]

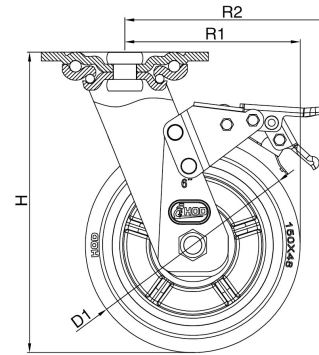

Spec. Demonstration



| Wheel Dia (in) | Tread Width (mm) | Load Height (mm) | Swivel Radius S1/S2/S3 (mm) | Plate Size A1xB1 (mm) | Plate Size A2xB3/A3xB2 (mm) | Hole Size (mm) |
|----------------|------------------|------------------|-----------------------------|-----------------------|------------------------------|----------------|
| 4" | 45-50 | 144 | 81 / 91 / 129 | 115x100 | A2xB3: 92x67 A3xB2: 76x76 | 11 |
| 5" | 45-50 | 165 | 96 / 96 / 129 | 115x100 | A2xB3: 92x67 A3xB2: 76x76 | 11 |
| 6" | 45-50 | 191 | 115 / 115 / 141 | 115x100 | A2xB3: 92x67 A3xB2: 76x76 | 11 |
| 8" | 45-50 | 242 | 150 / 150 / 150 | 115x100 | A2xB3: 92x67 A3xB2: 76x76 | 11 |

4"~8" Fork Option Zinc/Wrinkle Black Color Paint



7360110
Top Plate Rigid



7360120
Top Plate Swivel



7360121
Swivel Side Lock (Metal)



7360123
Swivel Total Lock (Metal)

Fork Finished Options



Blue Zinc



Wrinkle Black Color Paint

Brake Options

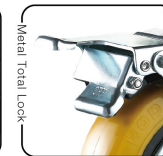

4" / 8"
Plate Thickness: 6.0(mm)
Fork Thickness: 6.0(mm)

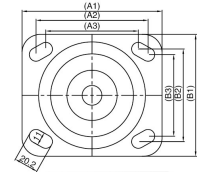

Conventional Plate



Sample Item Number

7360123-346

Heavy Duty

Wheel Size

Zinc Plated

Swivel

Total Lock
Brake (Metal)

Wheel Material

Double Ball
Bearing



A1 LOW GRAVITY CASTER SERIES 2.5"~3" 200~280kg



A2 HEAVY DUTY LOW GRAVITY CASTER SERIES 2.5"~3" 400~500kg

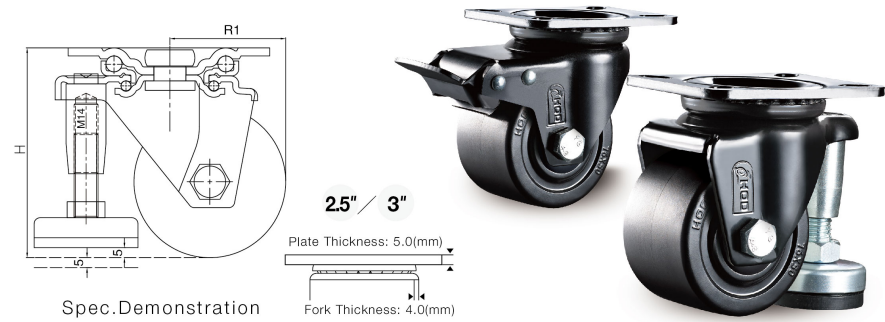

Wheel Option 2.5"~3"

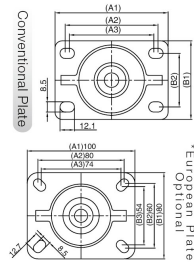
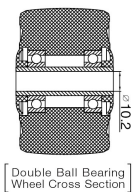

| Wheel Dia (in) | Tread Width (mm) | Load Height (mm) | Swivel Radius (mm) | Plate Size A1xB1 (mm) | Plate Size A2xB2/A3xB3 (mm) | Hole Size (mm) |
|----------------|------------------|------------------|--------------------|-----------------------|------------------------------|----------------|
| 2.5" | 45 | 85 | 57 | 95 X 66 | A2xB2: 78x45 A3xB3: 71x45 | 8.5 |
| 3" | 45 | 98 | 64 | 95 X 66 | A2xB2: 78x45 A3xB3: 71x45 | 8.5 |

Wheel Option 2.5"~3"

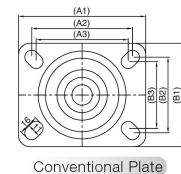
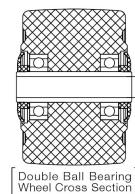

| Wheel Dia (in) | Tread Width (mm) | Load Height (mm) | Swivel Radius S1/S2 (mm) | Plate Size A1xB1 (mm) | Plate Size A2xB2/A3xB3 (mm) | Hole Size (mm) |
|----------------|------------------|------------------|--------------------------|-----------------------|------------------------------|----------------|
| 2.5" | 50 | 96 | 58/98 | 100x82 | A2xB2: 80x60 A3xB3: 73x53 | 11 |
| 3" | 50 | 108 | 68/108 | 100x82 | A2xB2: 80x60 A3xB3: 73x53 | 11 |



Sample Item
Number

A130320-106

Low Gravity Wheel Size Black Color Paint Swivel Non Lock Brake Wheel Material Double Ball Bearing



Sample Item
Number

A230310T-406

Heavy Duty Low Gravity Wheel Size Black Color Paint Rigid Non Lock With Lever Brake Wheel Material Double Ball Bearing



A3 EXTRA HEAVY DUTY LOW GRAVITY CASTER SERIES

Wheel Dia **2.5"~3"** Load Capacity **KG 600~700kg**

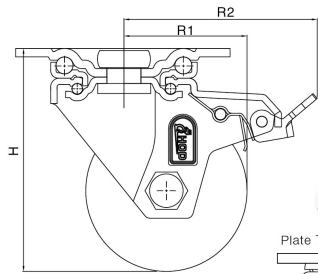

Spec. Demonstration



2.5" / 3"

Plate Thickness: 5.0(mm)

Fork Thickness: 4.0(mm)

Wheel Option **2.5"~3"**

2.5"~3" Black Color Paint Fork



PA400

Tread Width 50(mm)

2.5" / 600kg

3" / 700kg

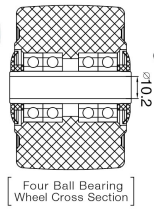

Four Ball Bearing
Wheel Cross Section



A330310
Top Plate Rigid

A330320
Top Plate Swivel

A330322
Swivel Wheel Lock(Metal)

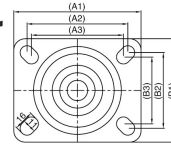

Conventional Plate

| Wheel Dia (in) | Tread Width (mm) | Load Height (mm) | Swivel Radius S1/S2 (mm) | Plate Size A1xB1 (mm) | Plate Size A2xB2/A3xB3 (mm) | Hole Size (mm) |
|----------------|------------------|------------------|--------------------------|-----------------------|------------------------------|----------------|
| 2.5" | 50 | 96 | 58 / 98 | 100x82 | A2xB2: 80x60 A3xB3: 73x53 | 11 |
| 3" | 50 | 108 | 68 / 108 | 100x82 | A2xB2: 80x60 A3xB3: 73x53 | 11 |



Sample Item Number

A330322-400

Extra Heavy Duty Low Gravity Wheel Size Black Color Paint Swivel Wheel Lock Brake (Metal) Wheel Material Four Ball Bearing

B1 CONDUCTIVE CASTER SERIES

Wheel Dia **3"~5"** Load Capacity **KG 85~115kg**

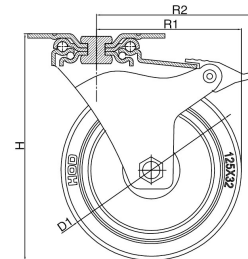

Spec. Demonstration

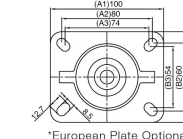
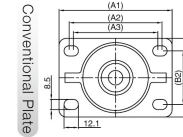

*European Plate Optional



Conductivity Coefficient **10³~10⁸**

Wheel Option **3"~5"**

3"~5" Zinc Plated Fork



TPR633

Tread Width 32(mm)

3" / 85kg

4" / 100kg

5" / 115kg

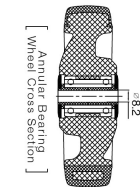

Annular Bearing
Wheel Cross Section

Plate Thickness: 3.0(mm)

Fork Thickness: 2.5(mm)



B140110
Top Plate Rigid

B140120
Top Plate Swivel

B140121
Swivel Side Lock (Metal)

B140123
Swivel Total Lock (Metal)

B140130
Threaded Stem

B140131
Threaded Side Lock (Metal)

B140133
Threaded Total Lock (Metal)

B140140
Hollow Rivet

B140141
Hollow Rivet Side Lock (Metal)

B140143
Hollow Rivet Total Lock (Metal)

| Wheel Dia (in) | Tread Width (mm) | Load Height (mm) | Swivel Radius S1/S2/S3 (mm) | Plate Size A1xB1 (mm) | Plate Size A2xB2/A3xB3 (mm) | Hole Size (mm) | Thread Size (mm) | Hollow Size (mm) |
|----------------|------------------|------------------|-----------------------------|-----------------------|------------------------------|----------------|------------------|------------------|
| 3" | 32 | 106 | 72.5 / 72.5 / 102 | 95 X 66 | A2xB2: 78x45 A3xB3: 71x45 | 8.5 | M12x25 | 12 |
| 4" | 32 | 131 | 85 / 85 / 107 | 95 X 66 | A2xB2: 78x45 A3xB3: 71x45 | 8.5 | M12x25 | 12 |
| 5" | 32 | 157 | 100.5 / 100.5 / 113 | 95 X 66 | A2xB2: 78x45 A3xB3: 71x45 | 8.5 | M12x25 | 12 |



Sample Item Number

B140123-633

Conductive Caster Wheel Size Zinc Plated Swivel Total Lock Brake (Metal) Wheel Material Annular Bearing



C1/C2 SERIES HIGH-TEMP. RESISTANCE CASTER SERIES

Wheel Dia 3"~5"

Load Capacity 100~150kg

Wheel Option 3"~5" | C1/C2 Series Capacity 100~150Kg

C1
-SERIES-

High-Temp. Nylon 482

200°C / 392°F
Maximum Temperature

3" / 100kg
4" / 115kg
5" / 150kg

C2
-SERIES-

High-Temp. Nylon 486

260°C / 500°F
Maximum Temperature

3" / 100kg
4" / 115kg
5" / 150kg

Spec. Demonstration

C1
-SERIES-

200°C / 392°F
Maximum Temperature

C2
-SERIES-

260°C / 500°F
Maximum Temperature

3"~5" Fork Option Zinc/Black

C240310
Top Plate Rigid

C240320
Top Plate Swivel

C240321
Swivel Side Lock (Metal)

C240323
Swivel Total Lock (Metal)

C240330
Threaded Stem

C240331
Threaded Side Lock (Metal)

C240333
Threaded Total Lock (Metal)

C240340
Hollow Rivet

C240341
Hollow Rivet Side Lock (Metal)

C240343
Hollow Rivet Total Lock (Metal)

| Wheel Dia (in) | Tread Width (mm) | Load Height (mm) | Swivel Radius S1/S2/S3 (mm) | Plate Size A1xB1 (mm) | Plate Size A2xB2/A3xB2 (mm) | Hole Size (mm) | Thread Size (mm) | Hollow Size (mm) |
|----------------|------------------|------------------|-----------------------------|-----------------------|------------------------------|----------------|------------------|------------------|
| 75 / 3" | 32 | 106 | 72.5 / 72.5 / 102 | 9.5 X 6.6 | A2xB2: 78x45 A3xB2: 71x45 | 8.5 | M12x25 | ∅ 12 |
| 100 / 4" | 32 | 131 | 85 / 85 / 107 | 9.5 X 6.6 | A2xB2: 78x45 A3xB2: 71x45 | 8.5 | M12x25 | ∅ 12 |
| 125 / 5" | 32 | 157 | 100.5 / 100.5 / 113 | 9.5 X 6.6 | A2xB2: 78x45 A3xB2: 71x45 | 8.5 | M12x25 | ∅ 12 |

Fork Finished Options

Brake Options

C240343-486

HIGH-TEMP. Resistance Caster

Wheel Size

Black Color Paint

Hollow Rivet

Total Lock Brake (Metal)

Wheel Material

Double Ball Bearing

3" / 5"

Plate Thickness: 3.0(mm)

Fork Thickness: 2.5(mm)

Conventional Plate

*European Plate Optional

*Variety of threaded stem and grip ring stem are optional.



D1 SERIES SHOCK ABSORBING DOUBLE BALL BEARING SERIES

Wheels Dia 5"~8"

Load Capacity 200~400kg

Wheel Option 5"~8" | D1 Series Capacity 200~400Kg



ALPU326



Tread Width 48(mm)
5" / 300kg
6" / 350kg
8" / 400kg



PU346



Tread Width 48(mm)
5" / 280kg
6" / 320kg
8" / 380kg



ER516



Tread Width 48(mm)
5" / 200kg
6" / 250kg
8" / 350kg

5"~8" Zinc Plated Fork



D160110
Top Plate Rigid



D160120
Top Plate Swivel



D160122
Swivel Wheel Lock
(Metal)



Brake Detailed View

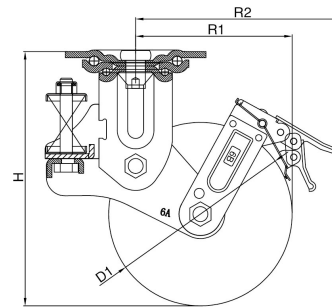

Spec. Demonstration



| Wheel Dia (in) | Tread Width (mm) | Load Height (mm) | Swivel Radius S1/S2 (mm) | Plate Size A1xB1 (mm) | Plate Size A2xB3/A3xB2 (mm) | Hole Size (mm) |
|----------------|------------------|------------------|--------------------------|-----------------------|------------------------------|----------------|
| 5" | 48 | 186 | 112 / 162 | 115x100 | A2xB3: 92x67 A3xB2: 76x76 | 11 |
| 6" | 48 | 210 | 128 / 171 | 115x100 | A2xB3: 92x67 A3xB2: 76x76 | 11 |
| 8" | 48 | 245 | 155 / 195 | 115x100 | A2xB3: 92x67 A3xB2: 76x76 | 11 |

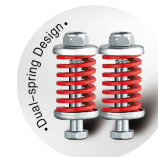

Application

- Reduce load capacity by 25% if caster is continually moving for 45 minutes.
- Reduce load capacity by 20% if caster is moving at the speed of 6kmph-10kmph(3.7 mph-6.2 mph).
- Reduce load capacity by 30% if caster is moving at the speed of 10kmph-16kmph(6.2 mph -9.9 mph).

For best performance use load capacity between 120 to 400 kg.



Sample Item Number

D160122-326

Shock Absorbing Caster | Wheel Size | Zinc Plated | Swivel | Wheel Lock Brake (Metal) | Wheel Material | Double Ball Bearing

5"
/
8"

Plate Thickness: 6.0(mm)
Fork Thickness: 5.0(mm)

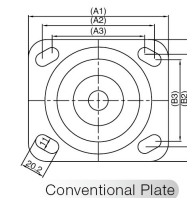

Conventional Plate

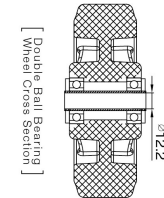

[Double Ball Bearing] Wheel Cross Section



E3 FOAM CASTER SERIES

Wheels Dia 6"~10"

Load Capacity 160~260kg

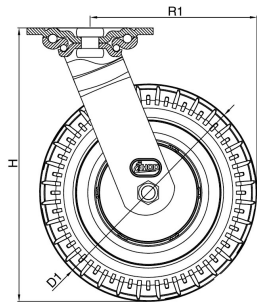

Spec. Demonstration

Plate Thickness: 5.0(mm)
Fork Thickness: 5.0(mm)

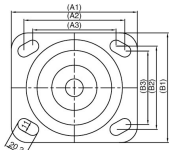

Conventional Plate



G3 PNEUMATIC CASTER SERIES

Wheels Dia 8"~10"

Load Capacity 160~220kg

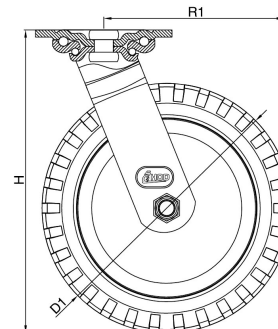

Spec. Demonstration



Wheel Option 6"~10"

6"~10" Yellow Zinc Plated Fork



FM716

Tread Width 57/64/70(mm)
6" / 160kg
8" / 210kg
10" / 260kg

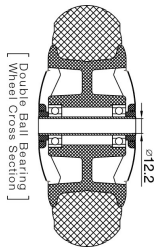

[Double Ball Bearing]
[Wheel Cross Section]

ø122



E360410
Top Plate Rigid



E360420
Top Plate Swivel



E360422
Swivel Wheel Lock
(Metal)

| Wheel Dia (in) | Tread Width (mm) | Load Height (mm) | Swivel Radius S1/S2 (mm) | Plate Size A1xB1 (mm) | Plate Size A2xB3/A3xB2 (mm) | Hole Size (mm) |
|----------------|------------------|------------------|--------------------------|-----------------------|------------------------------|----------------|
| 6" | 57 | 190 | 116 / 163 | 115x100 | A2xB3: 92x67 A3xB2: 76x76 | 11 |
| 8" | 64 | 250 | 153 / 189 | 115x100 | A2xB3: 92x67 A3xB2: 76x76 | 11 |
| 10" | 70 | 295 | 186 / 202 | 115x100 | A2xB3: 92x67 A3xB2: 76x76 | 11 |

Wheel Option 8"~10"

8"~10" Yellow Zinc Plated Fork



PN726

Tread Width 64/88(mm)
8" / 160kg
10" / 220kg

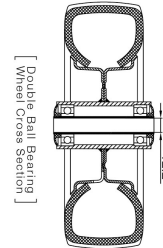

[Double Ball Bearing]
[Wheel Cross Section]

ø122



G3100410
Top Plate Rigid



G3100420
Top Plate Swivel

Plate Thickness: 5.0(mm)
Fork Thickness: 5.0(mm)

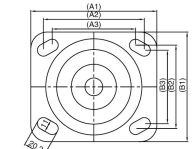

Conventional Plate

| Wheel Dia (in) | Tread Width (mm) | Load Height (mm) | Swivel Radius (mm) | Plate Size A1xB1 (mm) | Plate Size A2xB3/A3xB2 (mm) | Hole Size (mm) |
|----------------|------------------|------------------|--------------------|-----------------------|------------------------------|----------------|
| 8" | 64 | 258 | 156 | 115x100 | A2xB3: 92x67 A3xB2: 76x76 | 11 |
| 10" | 88 | 308 | 195 | 115x100 | A2xB3: 92x67 A3xB2: 76x76 | 11 |



Sample Item Number

E360422-716

Foam Caster Wheel Size Yellow Zinc Plated Swivel Wheel Lock Brake (Metal) Wheel Material Double Ball Bearing



Sample Item Number

G3100410-726

Pneumatic Caster Wheel Size Yellow Zinc Plated Rigid Non Lock Brake Wheel Material Double Ball Bearing



H7 MEDICAL CASTER SERIES

Wheels Dia **2.5"~4"** Load Capacity **55~100kg**

H8 MEDICAL CASTER SERIES

Wheels Dia **~3"** Load Capacity **50kg**

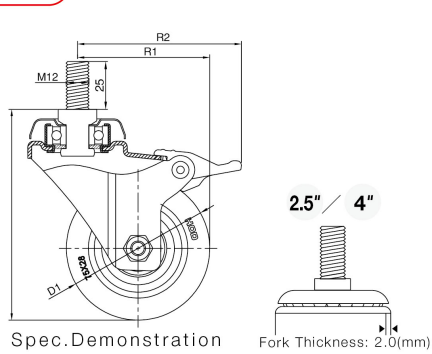

Wheel Option **2.5"~4"** **2.5"~4"** Zinc Plated Fork



PU276
Tread Width 28(mm)
2.5" / 70kg
3" / 85kg
4" / 100kg

TPR626
Tread Width 28(mm)
2.5" / 55kg
3" / 65kg
4" / 70kg

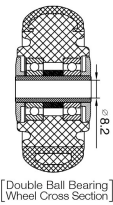

| Wheel Dia (in) | Tread Width (mm) | Load Height (mm) | Swivel Radius S1/S2 (mm) | Thread Size (mm) | Grip Ring Stem (mm) |
|----------------|------------------|------------------|--------------------------|------------------|---------------------|
| 2.5" | 28 | 97 | 62.5 / 93 | M12x25 | ∅11x38 |
| 3" | 28 | 112 | 69.5 / 93 | M12x25 | ∅11x38 |
| 4" | 28 | 137 | 84 / 97 | M12x25 | ∅11x38 |

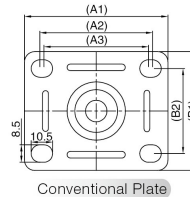
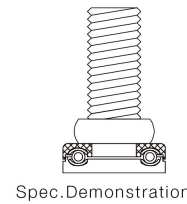

Brake Detailed View



| Wheel Dia (in) | Tread Width (mm) | Load Height Swivel/Extended (mm) | Swivel Radius S1/S2 (mm) | Plate Size (mm) A1xB1 | Plate Size (mm) A2xB2/A3xB2 | Hole Size (mm) | Thread Size (mm) | Grip Ring Stem (mm) |
|----------------|------------------|----------------------------------|--------------------------|-----------------------|--------------------------------|----------------|------------------|---------------------|
| 3" | 60 | 90 / 97 | 60 / 73 | 70x58 | A2xB2:55x41.5 A3xB2:53x41.5 | 8.5 | M12x25 | ∅11x38 |

H730164-276

Medical Caster Wheel Size Zinc Plated Grip Ring Stem Total Lock Brake (Plastic) Wheel Material Double Ball Bearing

Sample Item Number

H830124-212

Medical Caster Wheel Size Zinc Plated Swivel Total Lock Brake (Plastic) Wheel Material Nylon Bushing Bearing

Sample Item Number



H9
SERIES

MEDICAL CASTER SERIES

Wheels Dia **2.5"**

KG **~50kg**
Load Capacity

H9
SERIES

MEDICAL CASTER SERIES

Wheels Dia **4"**

KG **~70kg**
Load Capacity

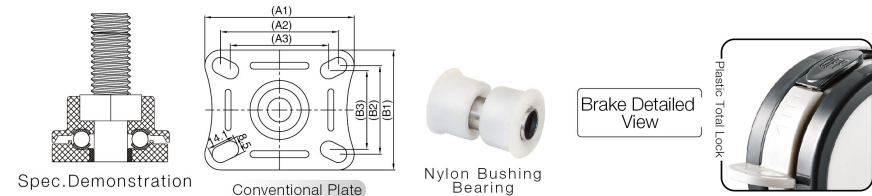
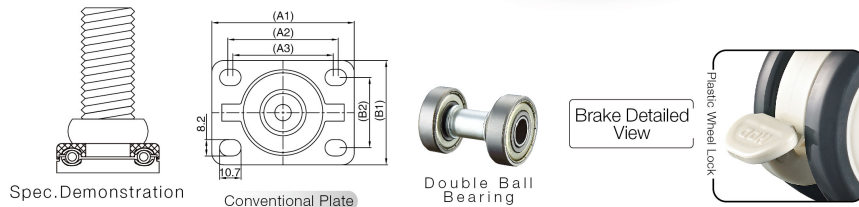

| Wheel Dia (in) | Tread Width (mm) | Load Height Swivel/Threaded (mm) | Swivel Radius S1/S2 (mm) | Plate Size (mm) A1xB1 | Plate Size (mm) A2xB2/A3xB3 | Hole Size (mm) | Thread Size (mm) | Grip Ring Stem (mm) |
|----------------|------------------|----------------------------------|--------------------------|-----------------------|--------------------------------|----------------|------------------|---------------------|
| 2.5" | 50 | 80/73 | 49/62 | 95 x 66 | A2xB2:55 x 35 A3xB3:50 x 35 | 8.2 | M10x15 | ∅11x38 |

| Wheel Dia (in) | Tread Width (mm) | Load Height Swivel/Threaded (mm) | Swivel Radius S1/S2 (mm) | Plate Size (mm) A1xB1 | Plate Size (mm) A2xB2/A3xB3 | Hole Size (mm) | Thread Size (mm) | Grip Ring Stem (mm) |
|----------------|------------------|----------------------------------|--------------------------|-----------------------|--------------------------------|----------------|------------------|---------------------|
| 4" | 65 | 130/122 | 80/100 | 88x72 | A2xB2:70 x 55 A3xB3:60 x 50 | 8.5 | M12x25 | ∅11x38 |



Sample Item Number

H925135-216

Medical Caster Wheel Size Zinc Plated Threaded Stem Wheel Lock Brake (Plastic) Wheel Material Double Ball Bearing



Sample Item Number

H940124-212

Medical Caster Wheel Size Zinc Plated Swivel Total Lock Brake (Plastic) Wheel Material Nylon Bushing Bearing



T1 TROLLEY CASTER SERIES

Wheels Dia **4"~5"**

Load Capacity **140~150kg**

92 EXTRA HEAVY DUTY DOUBLE BALL BEARING PA CASTER SERIES

Load Capacity **2000~4000kg**

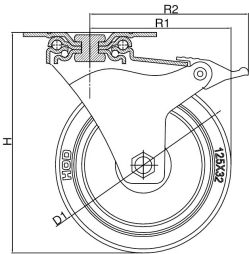

Spec. Demonstration

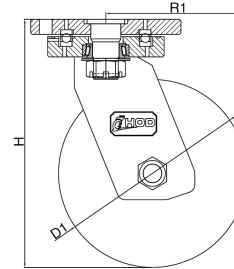

Plane Bearing Demonstration

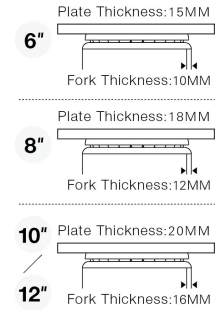

Wheel Option 4"~5"

4"~5" Black Color Paint Fork



ER505

Tread Width 32(mm)
4" / 140kg
5" / 150kg

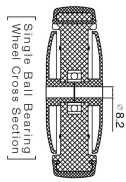

T140310
Top Plate Rigid

T140320
Top Plate Swivel

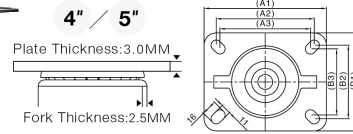

Conventional Plate

| Wheel Dia (mm) | Tread Width (mm) | Load Height (mm) | Swivel Radius (mm) S1/S2 | Plate Size (mm) (A1xB1) | Plate Size (mm) (A2xB2/A3xB3) | Hole Size (mm) |
|----------------|------------------|------------------|--------------------------|-------------------------|--|----------------|
| 100 / 4" | 32 | 131 | 52 / 107 | 100x80 | A2 x B2 : 80 x 60 A3 x B3 : 73 x 53 | 11 |
| 125 / 5" | 32 | 157 | 100.5 / 113 | 110x90 | A2 x B2 : 88 x 75 A3 x B3 : 81 x 68 | 11 |

Wheel Option 6"~12"

6"~12" Wrinkle Black Color Paint



PA406

Tread Width 70/85(mm)
6" / 2000kg
8" / 2500kg
10" / 3000kg
12" / 4000kg

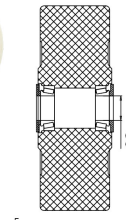

[Double Ball Bearing] Wheel Cross Section



9260610
Top Plate Rigid

9260620
Top Plate Swivel

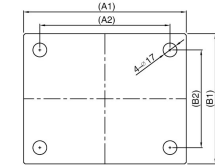

Conventional Plate

| Wheel Dia (mm) | Tread Width (mm) | Load Height (mm) | Swivel Radius (mm) | Plate Size (mm) (A1xB1) | Plate Size (mm) (A2xB2) | Hole Size (mm) |
|----------------|------------------|------------------|--------------------|-------------------------|-------------------------|----------------|
| 150 / 6" | 70 | 217 | 119 | 160 x 125 | 125 x 90 | 15 |
| 200 / 8" | 70 | 275 | 154 | 175 x 135 | 140 x 100 | 15 |
| 250 / 10" | 85 | 330 | 187 | 200 x 160 | 160 x 120 | 17 |
| 300 / 12" | 85 | 380 | 215 | 210 x 170 | 170 x 130 | 17 |



Caster Item Number

T150320-505

Trolley Caster Wheel Size Black Color Paint Swivel Non Lock Brake Wheel Material Single Ball Bearing



Caster Item Number

92100610-406

Extra Heavy Duty Caster Wheel Size Wrinkle Black Color Paint Rigid Non Lock Brake Wheel Material Double Ball Bearing

NOTE PAGE

NOTE PAGE

Our Brands



www.alrawaa.co

WARRANTY



Each ARG T product is warranted against defects in material and workmanship for one year from the date of original purchase, unless it has been misused, abused, modified, or improperly installed. Any products that is claimed to be defective and is returned to ARG T with its prior written approval will be repaired or replaced free of charge, excluding freight and installation. This warranty is exclusive and there are no other warranties, express or implied, such as an implied warranty or merchantability or fitness for particular purchase. This remedy is the sole remedy in contract, tort, or otherwise, and ARG T is not liable for incidental, consequential or special damages.



AL RAWAA GENERAL TRADING LLC.